

A417 Missing Link
TR010056

2.3 Special Category Land Plans (Rev 1)

Planning Act 2008

APFP Regulation 5(2)(i)(IV)
Infrastructure Planning (Applications: Prescribed Forms and
Procedure) Regulations 2009

Volume 2

October 2021

Infrastructure Planning

Planning Act 2008

**The Infrastructure Planning
(Applications: Prescribed Forms
and Procedure) Regulations 2009**

A417 Missing Link

Development Consent Order 202[x]

2.3 Special Category Land Plans

Regulation Number:	5(2)(i)(IV)
Planning Inspectorate scheme Reference	TR010056
Application Document Reference	2.3
Author:	A417 Missing Link

Version	Date	Status of Version
C01	May 2021	Application Submission
C02	October 2021	Procedural Deadline A

Contents

1. 2.3 Special Category Land Plans APFP Regulation 5(2)(i)(IV) Key Plan (C02)
2. 2.3 Special Category Land Plans APFP Regulation 5(2)(i)(IV) Sheet 1 of 6 (C01)
3. 2.3 Special Category Land Plans APFP Regulation 5(2)(i)(IV) Sheet 2 of 6 (C01)
4. 2.3 Special Category Land Plans APFP Regulation 5(2)(i)(IV) Sheet 3 of 6 (C01)
5. 2.3 Special Category Land Plans APFP Regulation 5(2)(i)(IV) Sheet 4 of 6 (C01)
6. 2.3 Special Category Land Plans APFP Regulation 5(2)(i)(IV) Sheet 5 of 6 (C01)
7. 2.3 Special Category Land Plans APFP Regulation 5(2)(i)(IV) Sheet 6 of 6 (C01)



SCALE 1:500 INSET A

Badgeworth CP

Cowley CP

This map is reproduced from Ordnance Survey material with the permission of Ordnance Survey on behalf of the controller of Her Majesty's Stationery Office. © Crown Copyright. Unauthorised reproduction infringes Crown copyright and may lead to prosecution or civil proceedings. CLIENT NAME: Highways England LICENCE NUMBER: 100030649 (2019) © Crown copyright material reproduced only with the permission of Land Registry.

- LEGEND**
- PARISH BOUNDARY
 - - - DEVELOPMENT CONSENT ORDER BOUNDARY
 - EXISTING FOOTPATH
 - EXISTING BRIDLEWAY
 - EXISTING RESTRICTED BYWAY
 - EXISTING NATIONAL TRAIL
 - SPECIAL CATEGORY LAND - REPLACEMENT COMMON LAND
 - COMMON LAND
 - SPECIAL CATEGORY LAND - COMMON LAND - LAND TO BE PERMANENTLY ACQUIRED
 - SPECIAL CATEGORY LAND - COMMON LAND - TEMPORARY POSSESSION
 - NATIONAL TRUST
 - SPECIAL CATEGORY LAND - NATIONAL TRUST - LAND TO BE PERMANENTLY ACQUIRED
 - NATIONAL TRUST / OPEN SPACE
 - SPECIAL CATEGORY LAND - NATIONAL TRUST / OPEN SPACE - LAND TO BE PERMANENTLY ACQUIRED
 - OPEN SPACE
 - SPECIAL CATEGORY LAND - OPEN SPACE - LAND TO BE PERMANENTLY ACQUIRED
 - SPECIAL CATEGORY LAND - OPEN SPACE - LAND TO BE USED TEMPORARILY AND RIGHTS TO BE ACQUIRED PERMANENTLY
 - SPECIAL CATEGORY LAND - OPEN SPACE - LAND TO BE USED TEMPORARILY

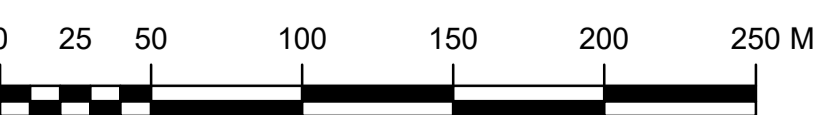
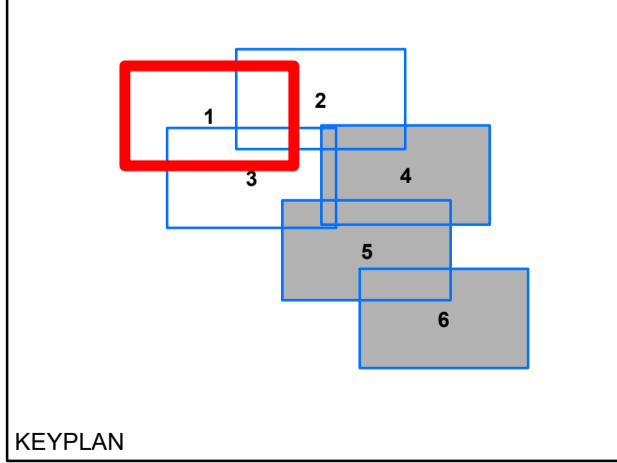

NOTES:
1. These Special Category Land Plans should be read in conjunction with other plans and documents in the Development Consent Order, in particular the Statement of Reasons

Rev	Date	Description	By	Chk'd	App'd	Auth'd
C01	13/04/2021	APPLICATION SUBMISSION (MAY 2021)	EB	JP	DB	SW

Suitability	A3	Drawing Status	STAGE COMPLETED	Project Title	A417 MISSING LINK				
				Drawing Title	SPECIAL CATEGORY LAND PLANS APFP REGULATION 5(2)(i)(IV) SHEET 1 OF 6				
Scale	1:2,500	By	EB	Checked	JP	Approved	DB	Authorised	SW
Original Size	A1	Date	13/04/21	Date	13/04/2021	Date	13/04/2021	Date	13/04/2021
Drawing Number	HE PIN	Originator	ARP	Volume	LSI	C01			
HE551506		-DR-ZL-001001		X_XX_XXXX_X					
Location		Type		Rate		Number			



CONTINUED ON SHEET 2

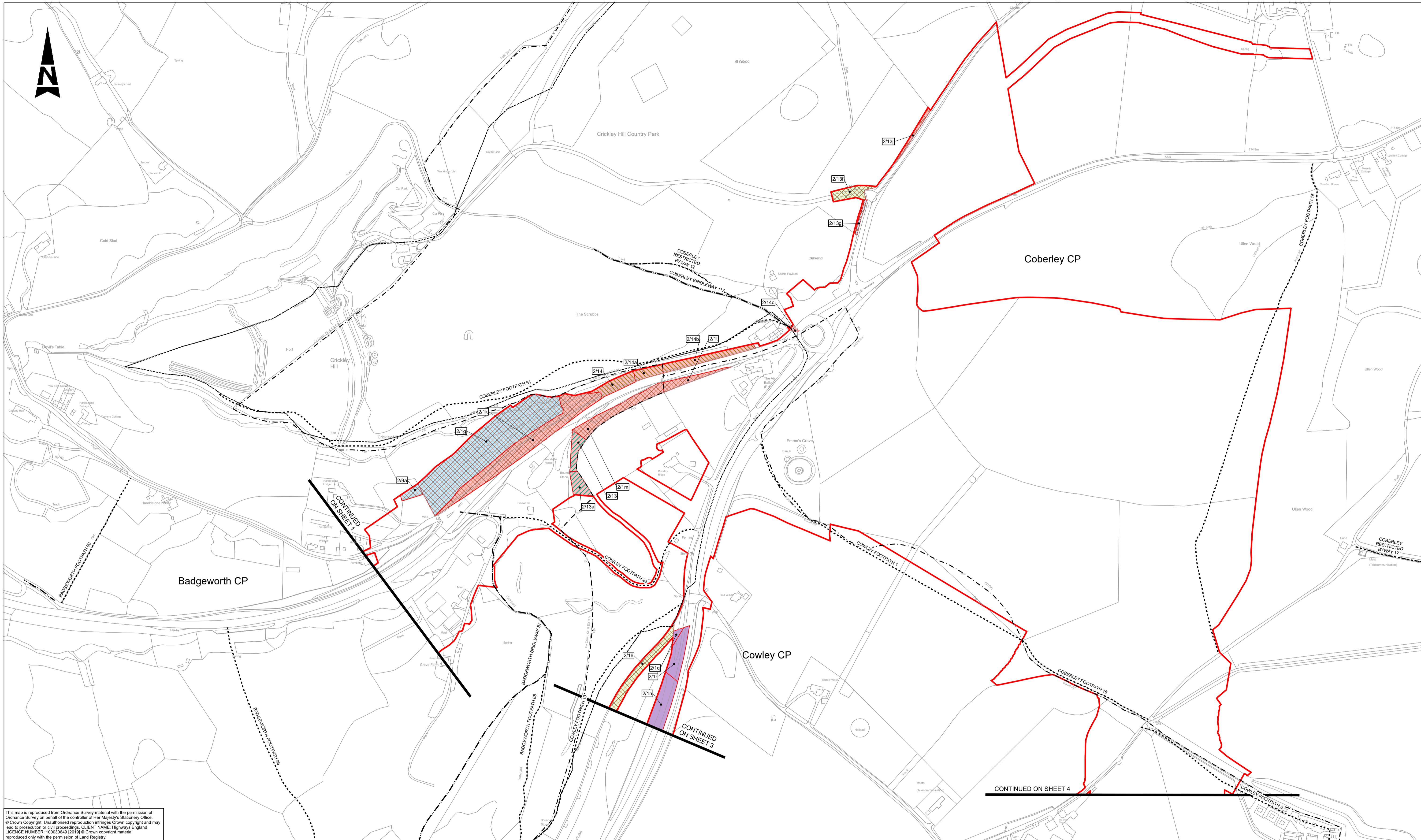

This map is reproduced from Ordnance Survey material with the permission of Ordnance Survey on behalf of the controller of Her Majesty's Stationery Office. © Crown Copyright. Unauthorised reproduction infringes Crown copyright and may lead to prosecution or civil proceedings. CLIENT NAME: Highways England LICENCE NUMBER: 100030649 (2019) © Crown copyright material reproduced only with the permission of Land Registry.

LEGEND

—	PARISH BOUNDARY	■	SPECIAL CATEGORY LAND - REPLACEMENT COMMON LAND
- - -	DEVELOPMENT CONSENT ORDER BOUNDARY	■	COMMON LAND
—	EXISTING FOOTPATH	■	SPECIAL CATEGORY LAND - COMMON LAND - LAND TO BE PERMANENTLY ACQUIRED
- - -	EXISTING BRIDLEWAY	■	SPECIAL CATEGORY LAND - COMMON LAND - TEMPORARY POSSESSION
- - -	EXISTING RESTRICTED BYWAY	■	NATIONAL TRUST
- - -	EXISTING NATIONAL TRAIL	■	SPECIAL CATEGORY LAND - NATIONAL TRUST - LAND TO BE PERMANENTLY ACQUIRED
		■	NATIONAL TRUST / OPEN SPACE
		■	SPECIAL CATEGORY LAND - NATIONAL TRUST / OPEN SPACE - LAND TO BE PERMANENTLY ACQUIRED
		■	OPEN SPACE
		■	SPECIAL CATEGORY LAND - OPEN SPACE - LAND TO BE PERMANENTLY ACQUIRED
		■	SPECIAL CATEGORY LAND - OPEN SPACE - LAND TO BE USED TEMPORARILY AND RIGHTS TO BE ACQUIRED PERMANENTLY
		■	SPECIAL CATEGORY LAND - OPEN SPACE - LAND TO BE USED TEMPORARILY

NOTES:
1. These Special Category Land Plans should be read in conjunction with other plans and documents in the Development Consent Order, in particular the Statement of Reasons

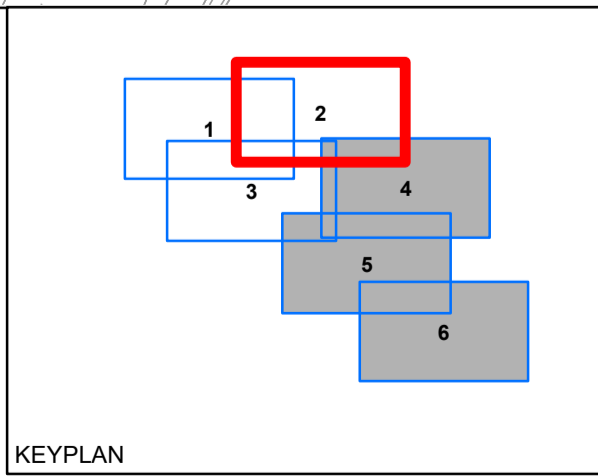
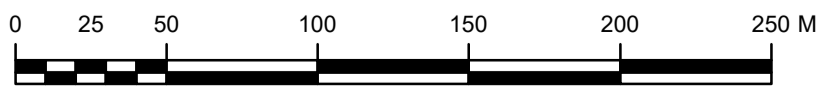

C01	13/04/2021	APPLICATION SUBMISSION (MAY 2021)	EB	JP	DB	SW
Rev	Date	Description	By	Chk'd	App'd	Auth'd

Suitability	A3	Drawing Status	STAGE COMPLETED	Project Title	A417 MISSING LINK				
				Drawing Title	SPECIAL CATEGORY LAND PLANS APFP REGULATION 5(2)(i)(IV) SHEET 2 OF 6				
Scale	1:2,500	By	EB	Checked	JP	Approved	DB	Authorised	SW
Original Size	A1	Date	13/04/21	Date	13/04/2021	Date	13/04/2021	Date	13/04/2021
Drawing Number	HE PIN	Originator	ARP	Volume	LSI	C01			
HE551506		-DR - ZL - 001002		X XX XXXX X					
Location		Type		Rate		Number			



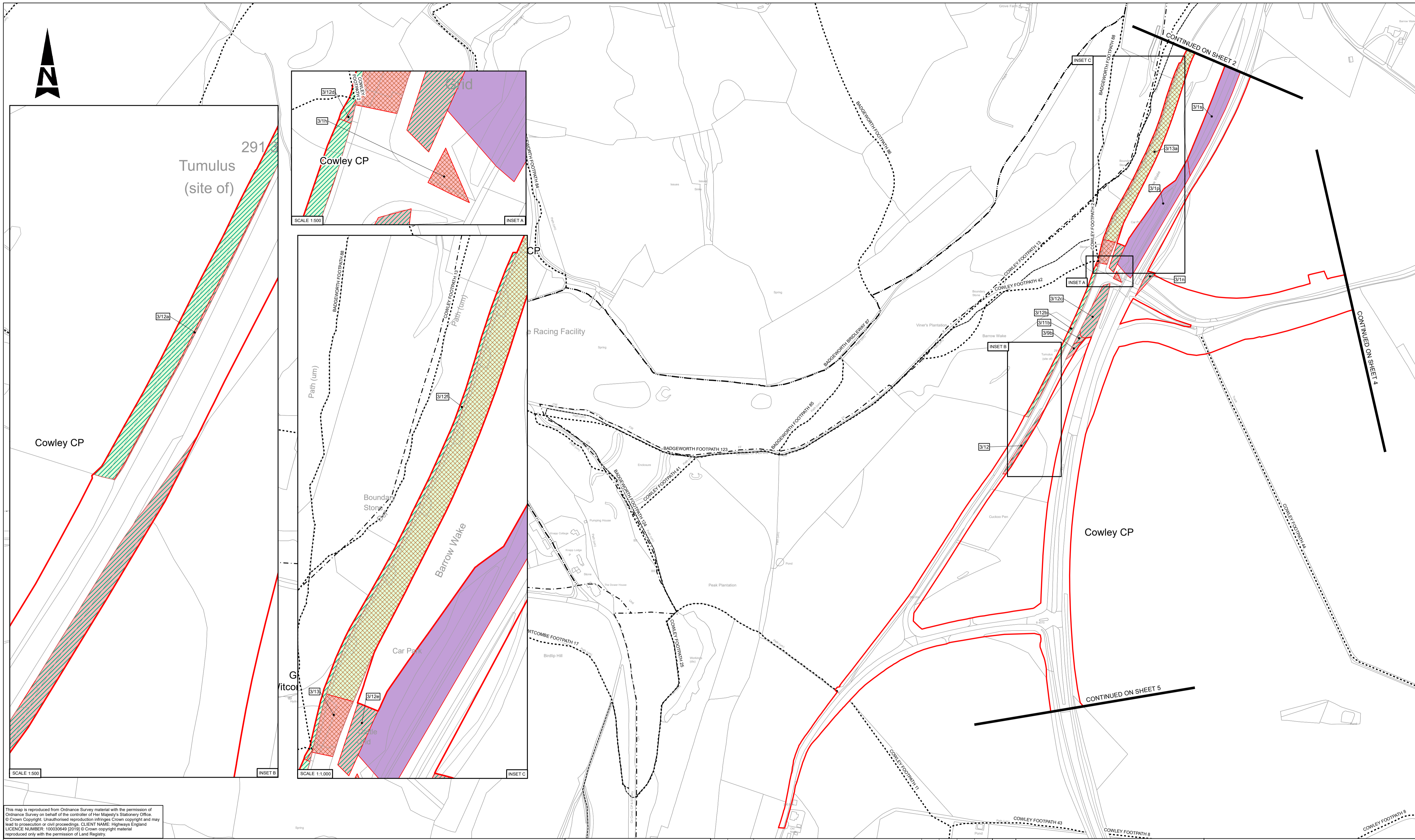

This map is reproduced from Ordnance Survey material with the permission of Ordnance Survey on behalf of the controller of Her Majesty's Stationery Office. © Crown Copyright. Unauthorised reproduction infringes Crown copyright and may lead to prosecution or civil proceedings. CLIENT NAME: Highways England LICENCE NUMBER: 100030649 [2019] © Crown copyright material reproduced only with the permission of Land Registry.

LEGEND	
—	PARISH BOUNDARY
—	DEVELOPMENT CONSENT ORDER BOUNDARY
---	EXISTING FOOTPATH
---	EXISTING BRIDLEWAY
---	EXISTING RESTRICTED BYWAY
---	EXISTING NATIONAL TRAIL
[Purple Box]	SPECIAL CATEGORY LAND - REPLACEMENT COMMON LAND
[Green Box]	SPECIAL CATEGORY LAND - COMMON LAND - LAND TO BE PERMANENTLY ACQUIRED
[Red Box]	SPECIAL CATEGORY LAND - COMMON LAND - TEMPORARY POSSESSION
[Orange Box]	NATIONAL TRUST
[Red Box]	SPECIAL CATEGORY LAND - NATIONAL TRUST - LAND TO BE PERMANENTLY ACQUIRED
[Orange Box]	NATIONAL TRUST / OPEN SPACE
[Orange Box]	SPECIAL CATEGORY LAND - NATIONAL TRUST / OPEN SPACE - LAND TO BE PERMANENTLY ACQUIRED
[Red Box]	OPEN SPACE
[Red Box]	SPECIAL CATEGORY LAND - OPEN SPACE - LAND TO BE PERMANENTLY ACQUIRED
[Red Box]	SPECIAL CATEGORY LAND - OPEN SPACE - LAND TO BE USED TEMPORARILY AND RIGHTS TO BE ACQUIRED PERMANENTLY
[Red Box]	SPECIAL CATEGORY LAND - OPEN SPACE - LAND TO BE USED TEMPORARILY

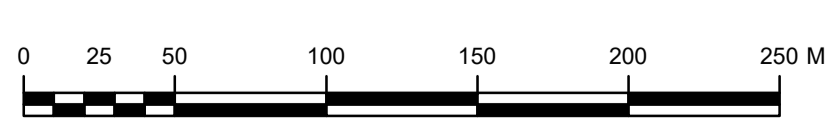
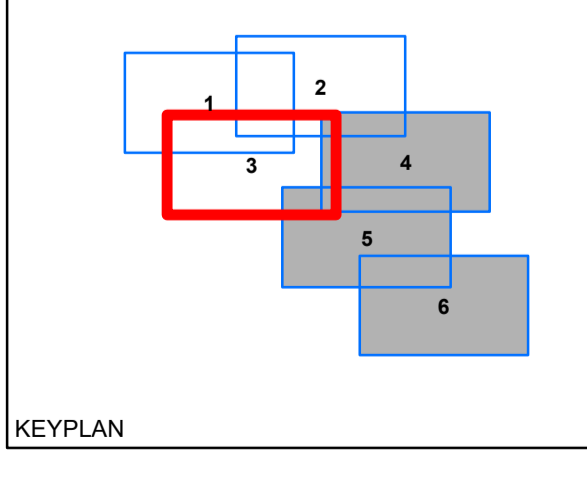

NOTES:
1. These Special Category Land Plans should be read in conjunction with other plans and documents in the Development Consent Order, in particular the Statement of Reasons

Rev	Date	Description	By	Chk'd	App'd	Auth'd
C01	13/04/2021	APPLICATION SUBMISSION (MAY 2021)	EB	JP	DB	SW

Suitability	A3	Drawing Status	STAGE COMPLETED	Project Title	A417 MISSING LINK						
				Drawing Title	SPECIAL CATEGORY LAND PLANS APFP REGULATION 5(2)(i)(IV) SHEET 3 OF 6						
Scale	1:2,500	By	EB	Checked	JP	Approved	DB	Authorised	SW		
Original Size	A1	Date	13/04/21	Date	13/04/2021	Date	13/04/2021	Date	13/04/2021		
Drawing Number	HE PIN	Originator	ARP	Volume	LSI						
	X_XX_XXXX_X	-DR - ZL - 001003								C01	



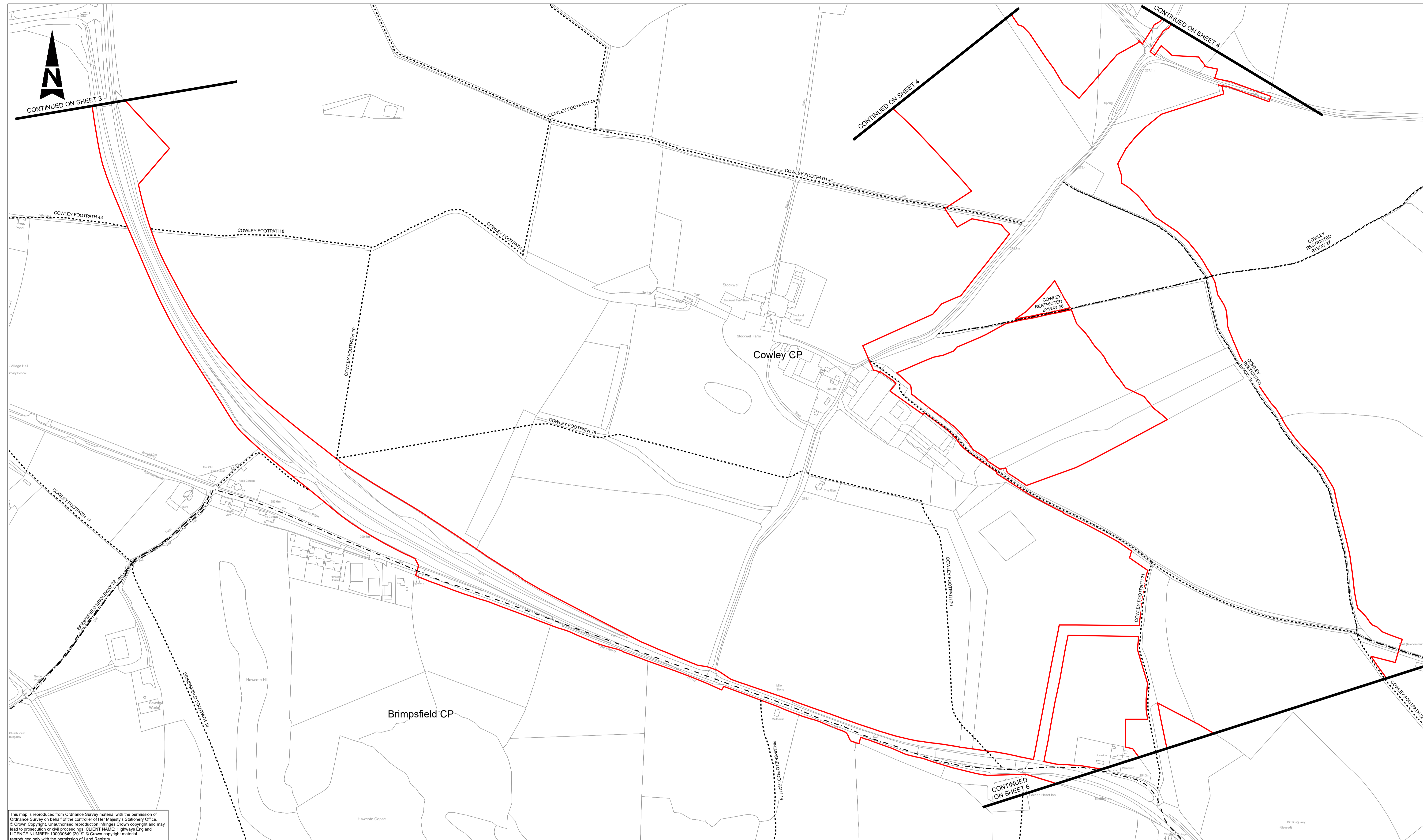

This map is reproduced from Ordnance Survey material with the permission of Ordnance Survey on behalf of the controller of Her Majesty's Stationary Office. © Crown Copyright. Unauthorised reproduction infringes Crown copyright and may lead to prosecution or civil proceedings. CLIENT NAME: Highways England LICENCE NUMBER: 100030649 [2019] © Crown copyright material reproduced only with the permission of Land Registry.

- LEGEND**
- PARISH BOUNDARY
 - DEVELOPMENT CONSENT ORDER BOUNDARY
 - EXISTING FOOTPATH
 - EXISTING BRIDLEWAY
 - EXISTING RESTRICTED BYWAY
 - EXISTING NATIONAL TRAIL

- SPECIAL CATEGORY LAND - REPLACEMENT COMMON LAND
- COMMON LAND
- SPECIAL CATEGORY LAND - COMMON LAND - LAND TO BE PERMANENTLY ACQUIRED
- SPECIAL CATEGORY LAND - COMMON LAND - TEMPORARY POSSESSION
- NATIONAL TRUST**
- SPECIAL CATEGORY LAND - NATIONAL TRUST - LAND TO BE PERMANENTLY ACQUIRED
- NATIONAL TRUST / OPEN SPACE**
- SPECIAL CATEGORY LAND - NATIONAL TRUST / OPEN SPACE - LAND TO BE PERMANENTLY ACQUIRED
- OPEN SPACE**
- SPECIAL CATEGORY LAND - OPEN SPACE - LAND TO BE PERMANENTLY ACQUIRED
- SPECIAL CATEGORY LAND - OPEN SPACE - LAND TO BE USED TEMPORARILY AND RIGHTS TO BE ACQUIRED PERMANENTLY
- SPECIAL CATEGORY LAND - OPEN SPACE - LAND TO BE USED TEMPORARILY

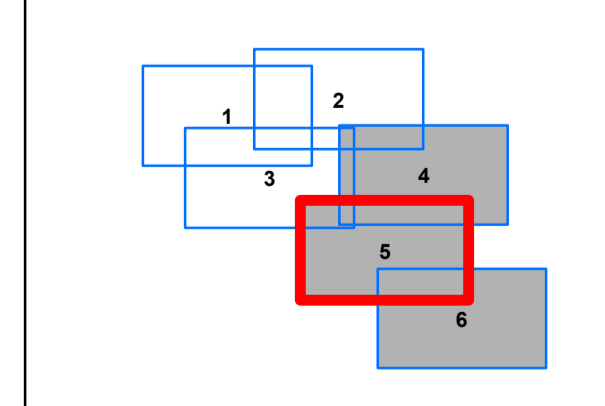

NO SPECIAL CATEGORY LAND SHOWN ON THIS SHEET

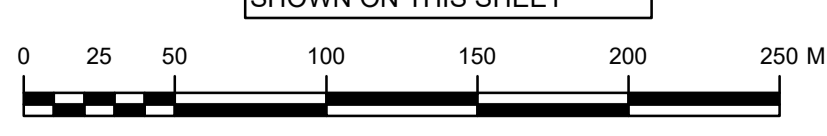

NOTES:
1. These Special Category Land Plans should be read in conjunction with other plans and documents in the Development Consent Order, in particular the Statement of Reasons

Rev	Date	Description	By	Chk'd	App'd	Auth'd
C01	13/04/2021	APPLICATION SUBMISSION (MAY 2021)	EB	JP	DB	SW

Suitability: A3 Drawing Status: STAGE COMPLETED

Client:

Project Title: A417 MISSING LINK

Drawing Title: SPECIAL CATEGORY LAND PLANS
APFP REGULATION 5(2)(i)(IV)
SHEET 5 OF 6

Scale	By	Checked	Approved	Authorised
1:2,500	EB	JP	DB	SW
Original Size	Date	Date	Date	Date
A1	13/04/21	13/04/2021	13/04/2021	13/04/2021
Drawing Number	HE PIN	Originator	Volume	Revision
HE551506 - ARP		LSI		C01
X_XX_XXXX_X		-DR - ZL - 002061		
Location	Type	Rate	Number	

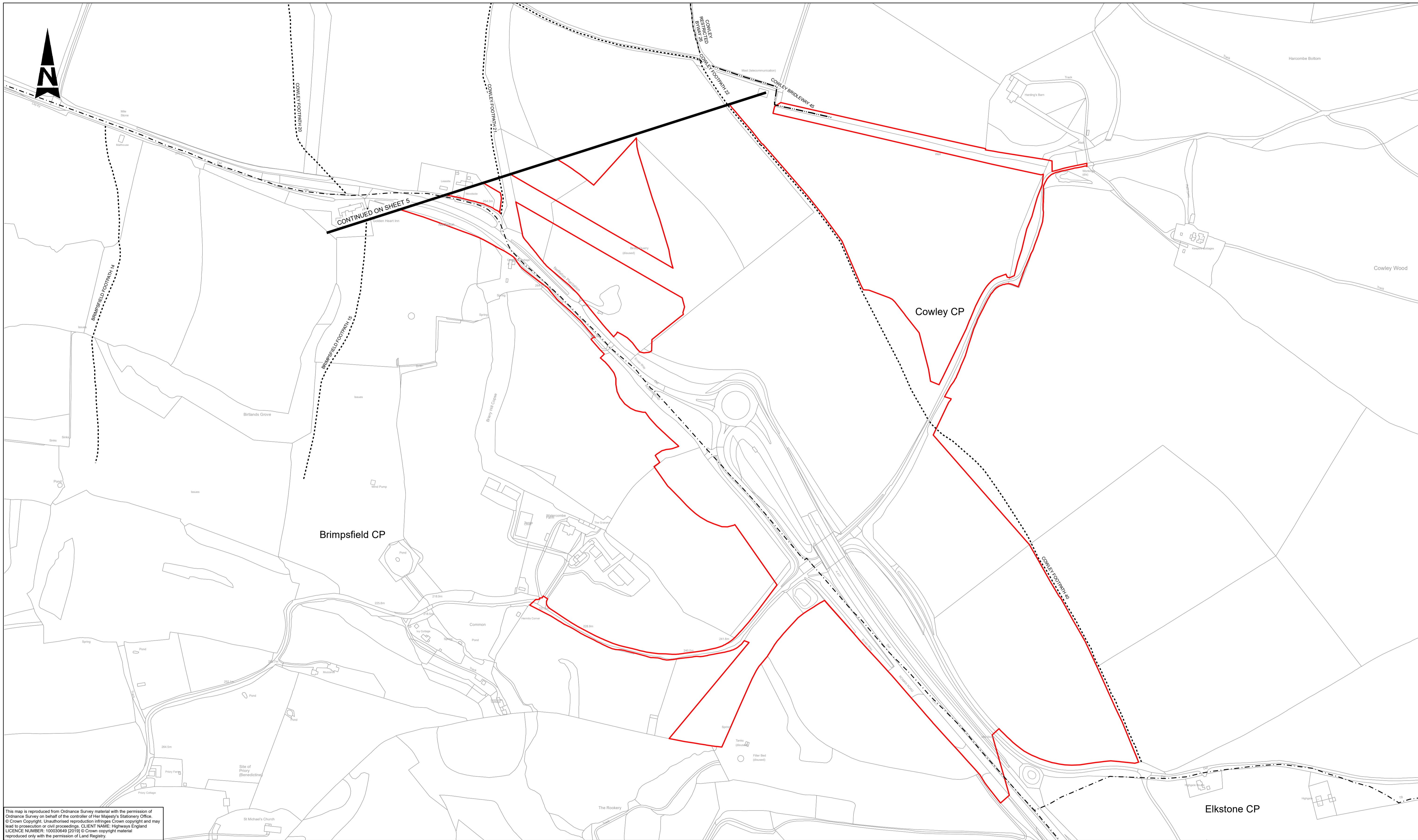

This map is reproduced from Ordnance Survey material with the permission of Ordnance Survey on behalf of the controller of Her Majesty's Stationery Office. © Crown Copyright. Unauthorised reproduction infringes Crown copyright and may lead to prosecution or civil proceedings. CLIENT NAME: Highways England LICENCE NUMBER: 100030649 (2019) © Crown copyright material reproduced only with the permission of Land Registry.

LEGEND
 L. - - - PARISH BOUNDARY
 - - - - - DEVELOPMENT CONSENT ORDER BOUNDARY
 - - - - - EXISTING FOOTPATH
 - - - - - EXISTING BRIDLEWAY
 - - - - - EXISTING RESTRICTED BYWAY
 - - - - - EXISTING NATIONAL TRAIL

- SPECIAL CATEGORY LAND - REPLACEMENT COMMON LAND
- COMMON LAND**
- SPECIAL CATEGORY LAND - COMMON LAND - LAND TO BE PERMANENTLY ACQUIRED
- SPECIAL CATEGORY LAND - COMMON LAND - TEMPORARY POSSESSION
- NATIONAL TRUST**
- SPECIAL CATEGORY LAND - NATIONAL TRUST - LAND TO BE PERMANENTLY ACQUIRED
- NATIONAL TRUST / OPEN SPACE**
- SPECIAL CATEGORY LAND - NATIONAL TRUST / OPEN SPACE - LAND TO BE PERMANENTLY ACQUIRED
- OPEN SPACE**
- SPECIAL CATEGORY LAND - OPEN SPACE - LAND TO BE PERMANENTLY ACQUIRED
- SPECIAL CATEGORY LAND - OPEN SPACE - LAND TO BE USED TEMPORARILY AND RIGHTS TO BE ACQUIRED PERMANENTLY
- SPECIAL CATEGORY LAND - OPEN SPACE - LAND TO BE USED TEMPORARILY

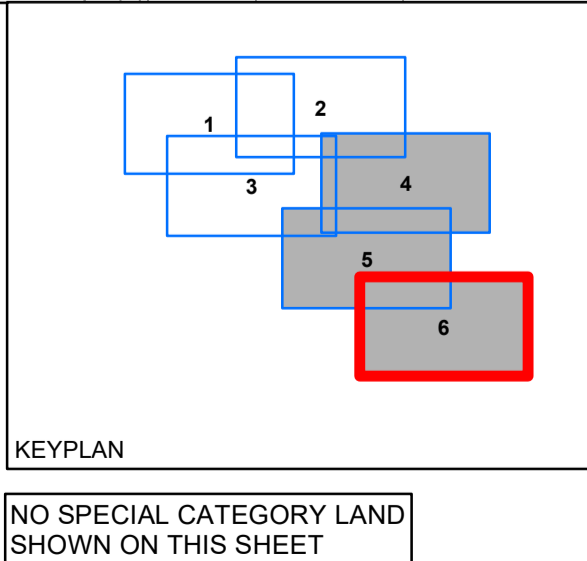

NOTES:
 1. These Special Category Land Plans should be read in conjunction with other plans and documents in the Development Consent Order, in particular the Statement of Reasons

Rev	Date	Description	By	Chk'd	App'd	Auth'd
C01	13/04/2021	APPLICATION SUBMISSION (MAY 2021)	EB	JP	DB	SW

Suitability: A3
 Drawing Status: STAGE COMPLETED

Project Title: A417 MISSING LINK

Drawing Title: SPECIAL CATEGORY LAND PLANS
 APFP REGULATION 5(2)(i)(IV)
 SHEET 6 OF 6

Scale	By	Checked	Approved	Authorised
1:2,500	EB	JP	DB	SW
Original Size	Date	Date	Date	Date
A1	13/04/21	13/04/2021	13/04/2021	13/04/2021
Drawing Number	HE PIN	Originator	Volume	Revision
HE551506	-	ARP	-	LSI
X_XX_XXXX_X	-	DR	-	ZL
				002062



C01